



GREEN PRO

Multi-Purpose Golf Accessory

The revolutionary way to repair pitchmarks and pick up your ball using your putter



GREEN PRO is a revolutionary, patented golf accessory, designed to allow golfers to repair pitchmarks and retrieve their ball without bending down - saving their backs and the greens!

The unique system allows either an interchangeable **ball retriever** or **pitchmark repairer** to be easily and quickly fitted to a clip-on base fixed to the putter.

The two tools are carried on a convenient accessory clip, which incorporates a **stiff club brush**, **scoring pencil** and **pencil sharpener**. The clip-on base also holds a **ball marker** and the ball retriever incorporates a **ball line marker guide**.

GREEN PRO is an invaluable aid to the many millions of golfers around the world who will now not have to repeatedly bend down to retrieve their ball or repair pitchmarks.

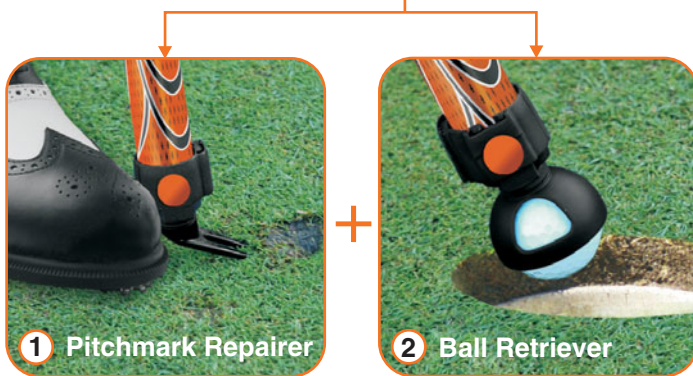

GREEN PRO gives 7 uses in one handy accessory:

- 1** Pitchmark Repairer
- 2** Ball Retriever
- 3** Club Brush
- 4** Scoring Pencil
- 5** Pencil Sharpener
- 6** Ball Marker & Holder
- 7** Ball Line Marker Guide

www.greenprogolf.com



Fitting Instructions

Clip-on Base:

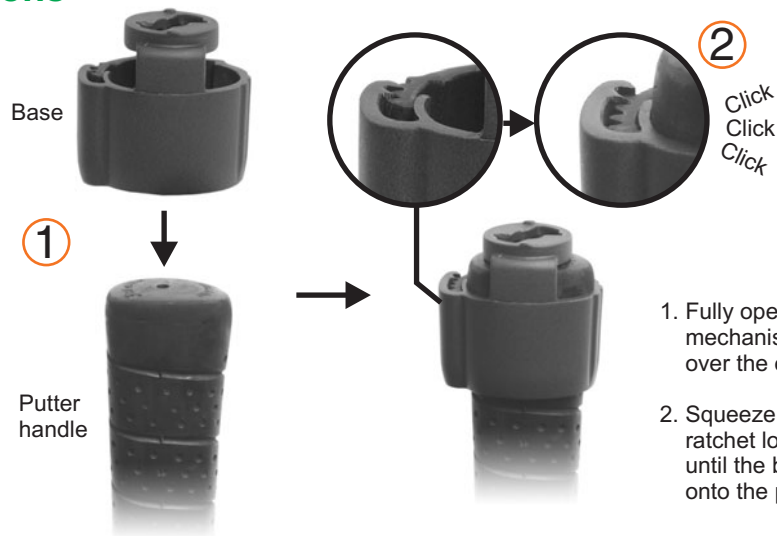

1. Fully open ratchet locking mechanism and slip the base over the end of the putter handle
2. Squeeze both sides of the ratchet locking mechanism until the base is tightly secured onto the putter handle

Accessory Tools:

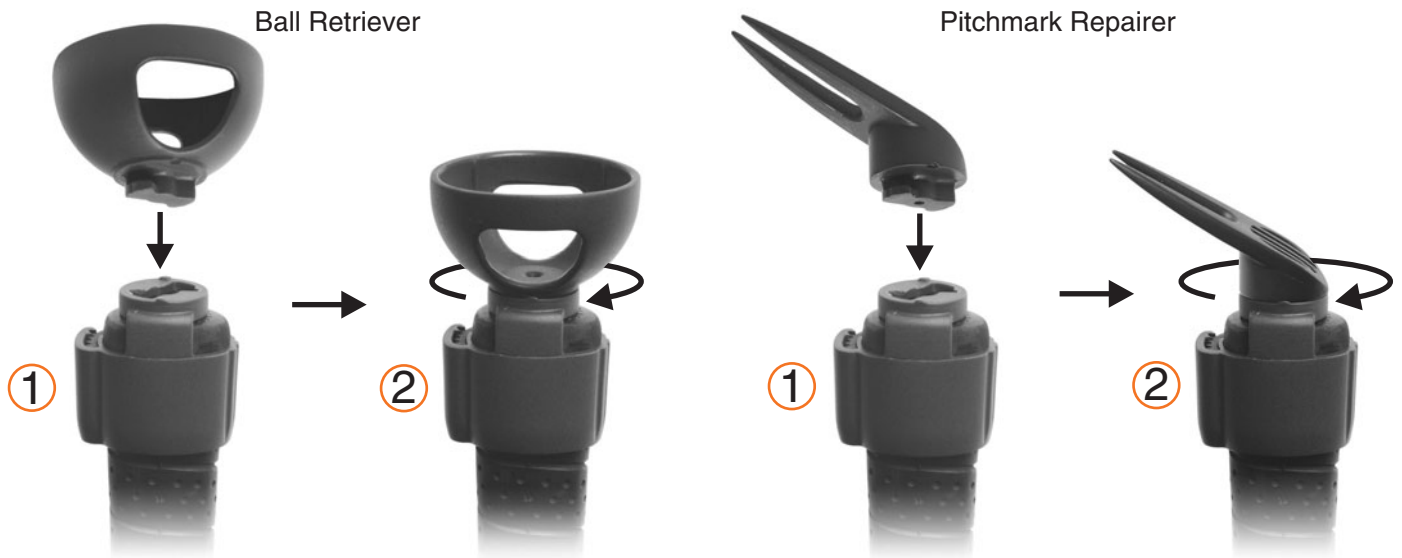

1. Insert the accessory tool into the base
2. Holding the base and putter with one hand, using the other hand, twist the accessory tool clockwise until it locks
3. After use, twist tool anti-clockwise to release and place back on carrier for future use

Repairing Pitchmarks

1. Insert the repair tool at the edge of the pitchmark, nudging it into the green with your foot
2. Lift up the centre of the indentation by pulling the putter towards you



Ball Marking

1. Insert ball into Ball Retriever and using a permanent marker pen draw a line on the ball using the slot as a guide.
2. The straight line helps with putting accuracy and ball identification.

